



wedi[™] corp.

wedi TECH TIP October 2007

New wedi Building Panel

For Exterior Use: BA BALCO

Dear valued wedi Customer,

Happy Halloween and Happy Thanksgiving! The coming holidays are sure to offer us a pleasant time for selling wedi products. We will all see a high in business due to builders wanting to remodel before the holidays and we will also find time to care for the humorous and relaxing things in life.

The humorous part becomes even more important due to the current economic development, especially in new residential construction. However, we should be relaxed as long as we have friends and customers who send us their hand carved pumpkins on which, in our case, a wedi PACMAN hunts a competitor's ghost. J

In this October issue of the wedi Tech Tip, I would like to introduce to you a new wedi Building Panel, specifically made for Exterior Use: **BA Balco**

I hope everyone has a Healthy and Happy Thanksgiving!

Sincerely,

Bastian Lohmann

Technical Sales Manager

WEDI NEWS TICKER:

- ü **New Product wedi 1/8" thick panel allows for thin and waterproof leveling jobs or applications on tub decks etc (sheet size 2 x 4 ft)**
- ü **Check re- designed and extended wedicorp.com website for massive information around the wedi system technology**

wedi BA Balco- Building Panel for Exterior Use on Balconies, Patios, Terraces

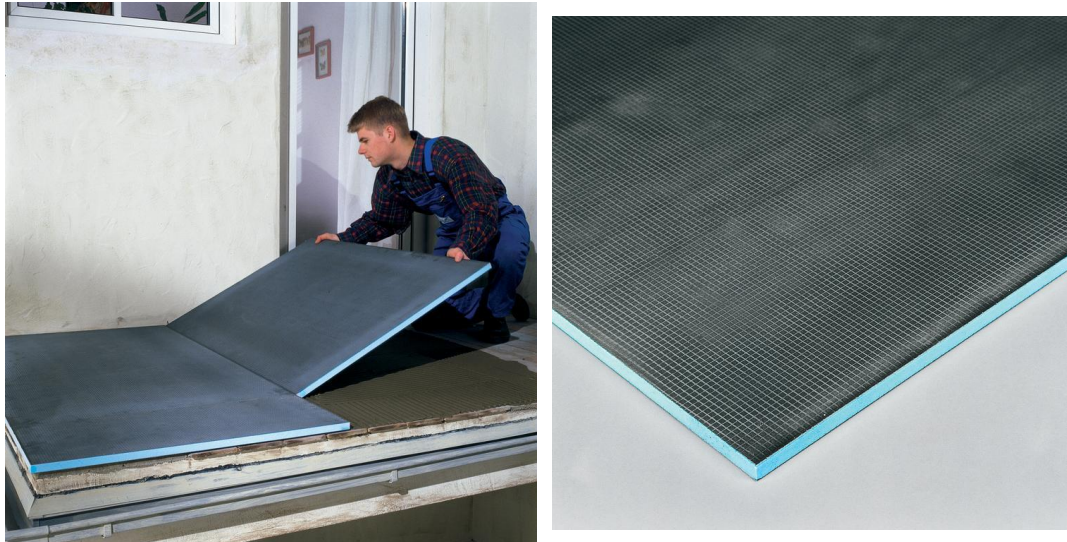

Traditionally, wedi used the regular building panels in interior and exterior applications making use of its waterproof properties. We also recommended the use of impermeable thin sets and grout fillers in combination with dense tile. This recommendation covers an issue well known to our trade and called “:freeze-thaw-cycle issue”. Especially, where horizontal areas such as patios are permanently exposed to the elements, absorption of water in thin set adhesive and grout can have fatal consequences, once freezing changes the water molecules to icy crystals which expand the volume of this element 9-11%. This can easily lead to cracking tiles. The regular wedi building panel would suffer too because it's cementitious based surface absorbs water (which is preferable in interior application on vertical walls to allow for better thin set bond) which can result in surface damages on wedi once the water content freezes. This can lead to bond failures of tile. Our recommendation for epoxy thin sets and grouts took care of this issue. At the same time, it made it more difficult and costly for our customer to use these materials. By the way, we believe that these materials should always be utilized especially where only little slope is existent underneath the surface and water will stand on and in the tile backing structure.

To allow for exterior grade modified thinsets and grouts in exterior applications, in which wedi would not be suffering under water and freeze exposure, we have conceived a new product which is available as per right now: wedi BA Balco. This panel has a surface coating which is totally impervious, specially hardened and sanded to allow for good grip of thin set mortar. It is available in 30 x 48”, thickness 3/8”.

We still recommend the following structure for installations on horizontal application:

1. Slope in stabil substrate required
2. wedi BA Balco applied in exterior grade thinset
3. All joints taped with wedi polyurethane sealant
4. Tile application in exterior grade thin set and grout fillers

wedi BA Balco on old tiled surface – a product not only for new construction!

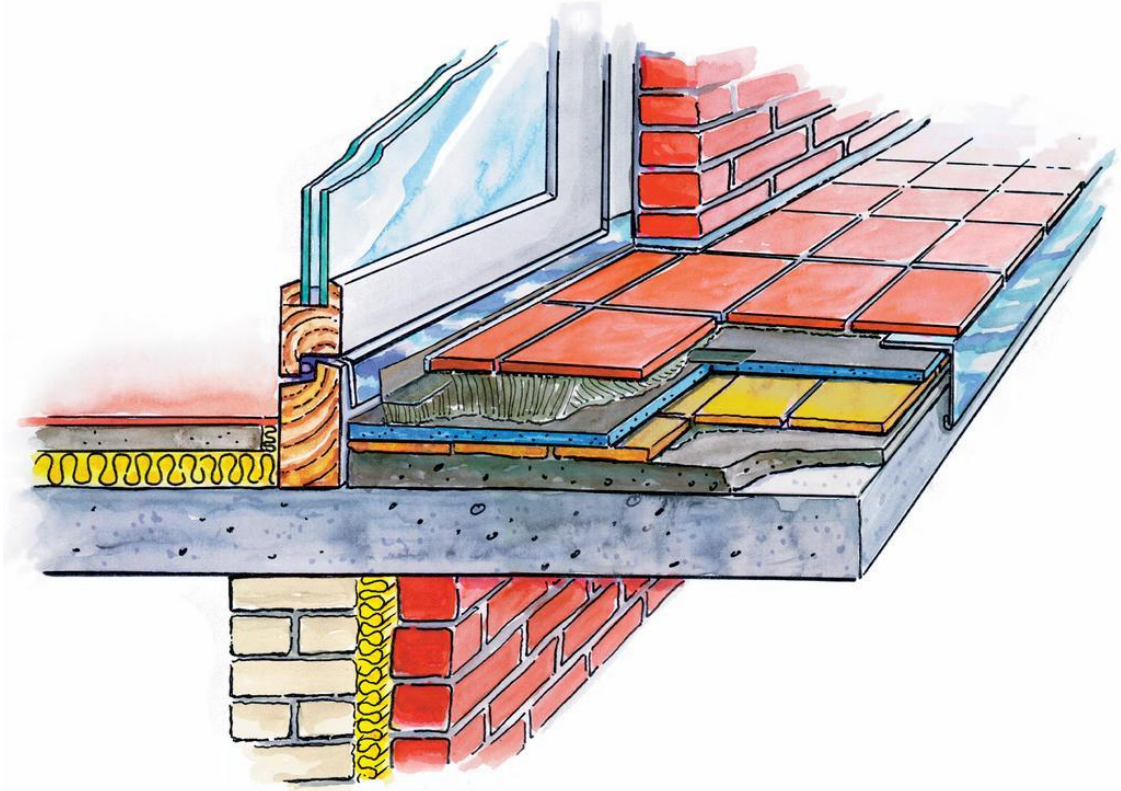

Where no slope is existing in the substrate- Use wedi BA Balco Sloped Panels !
Available in two different sizes to be used in combination

