

1 Step, 1 Solution, Many Benefits: wedi Subliner Dry & Flex PRO is the Best Solution at the Best Price

As a tile pro, you know that so much goes into great installations before tile and stone is set. For the best results, you've got to:

- Waterproof tile substrates to prevent mold and water damage in wet areas
- Protect tile work from cracks resulting from lateral movement caused by shrinking and expanding substrates on concrete slabs or wooden floors
- Provide sound isolation when installing above living areas
- Be safe in interior and exterior applications with challenging conditions

And you know that wedi Subliner Dry & Flex PRO is the one product that tackles all of the above in a single step. There was a time you would have needed different products installed in multiple steps to achieve all these benefits. That would add time and cost to your installations. Today, wedi's innovative peel & stick membrane keeps installation simple and minimizes the time and expense involved.

wedi Subliner Dry & Flex PRO eliminates costs associated with cement boards or uncoupling membranes used to prepare floors. Our system does not need thinset or fasteners; it's lightweight and allows for immediate tile setting. Though installation is quick, the quality is lasting; this superior substrate will help installations perform for decades.

In field performance and testing proves wedi Subliner Dry & Flex PRO has the technical characteristics you need at the price that's right!

1 Very Special Offer for You!

10% Off Purchases of 2 or more 165 sq. ft. rolls of wedi Subliner Dry & Flex PRO Now Through November 30, 2010!* Contact your wedi distributor today to get your 10% discount on all purchases of 2 rolls or more of Subliner Dry & Flex PRO!

**Offer valid through November 30, 2010. Some limitations may apply; see distributor for details.*

Just introduced to complete the Subliner PRO family:

Our PRO Asphalt Sealing Strips are the powerful finishing touch for patio installations and more applications that require fully waterproofed performance.

They're the ideal supplement to the performance power of Subliner Dry & Flex PRO in extremely water-exposed areas. The strips are used under seams of Subliner Dry & Flex PRO and fuse asphalt and asphalt together to achieve a waterproof and highly connective joint in a very even fashion.

Special Offer: **10% Off!**

Purchase 2 rolls or more **wedi Subliner Dry & Flex PRO** and save 10%!

Offer good now through November 30, 2010 while supplies last.

Contact your wedi distributor for details.



Technical Data Sheet



wedi® Subliner Dry & Flex PRO Waterproofing, Anti-Fracture & Sound Reducing Membrane

General Product Description

A peel and stick flexible underlayment with integral waterproofing, anti-fracture and sound reducing characteristics. The underlayment is made from highly tear-resistant nonwoven polypropylene material with rubberized asphaltic, pressure sensitive adhesive layer, which offers optimum connection to tile laying materials thanks to its special fleece lamination. For quick sealing measures for fixed-date building sites in combination with ceramic tiles and slabs as well as with natural cast tiles for indoor and outdoor floor areas. The special underlayment provides improved tension compensation during abrupt temperature changes. wedi® Subliner Dry & Flex PRO is 100% waterproof and will effectively protect the subfloor from moisture damage and cracks due to movement. It was successfully tested and exceeded criteria according to ANSI A118.12. It is tested to isolate cracks over and up to 3/8" — far exceeding the minimum capabilities of regular crack isolation membranes.

Application Areas

Suitable for residential and commercial applications where waterproof substrate preparation according to ANSI A118.10-1999 and crack isolation according to ANSI A118.12 are required including but not limited to:

- ✓ Indoor and outdoor use
- ✓ Balconies and patios
- ✓ Residential bathrooms
- ✓ Hotel bathrooms
- ✓ Shower facilities
- ✓ Areas around swimming pools
- ✓ Commercial kitchens and laundries
- ✓ Shopping malls
- ✓ Wood or concrete subfloors
- ✓ Areas requiring disabled access/ barrier-free applications
- ✓ Condominiums

Product Characteristics

- ✓ Waterproofing, anti-fracture and tension reducing
- ✓ Dramatically reduces the amount of thinset mortar used when compared to hard plastic thinset mortar membranes
- ✓ Any modified thinset mortar can be used to bond to tile and stone
- ✓ Sound control/isolation



- ✓ High tear resistance
- ✓ Alkali resistant
- ✓ Non-aging
- ✓ Non-decomposable
- ✓ Short installation time
- ✓ Tile ready upon installation
- ✓ Easy processing
- ✓ Low structural height (50 mil)
- ✓ Can be used with hot water under floor heating systems

Requirements On Floors

Wood and similar structural underlayments

General:

- Plywood, OSB, or concrete subfloor must be clean, even and load bearing.
- Any leveling of the subfloor must be done prior to installing.
- All subfloors must be primed using deep penetrating primer such as wedi® PRO Primer.
- Smooth non-absorbing subfloors, which are not to be removed, with self-etching primer.
- wedi® Subliner Dry & Flex PRO does not replace the need for movement joints including perimeter joints within the tiled finish surface. Install in accordance with industry standards and according to local building codes.
- On crawl space floors and in applications for roof patios over existing living space, vapor barriers must be installed according to local building codes (please contact wedi® Technical Services).
- Install ventilation where water vapor is present.



Technical Data Sheet:

wedi® Subliner Dry & Flex PRO | Waterproofing, Anti-Fracture & Sound Reducing Membrane

Setup over Wood Structure/Patio

Application Materials

1. PRO Primer
2. Subliner Dry & Flex PRO (Begin laying out Dry & Flex PRO at front end of patio.)
3. A Subliner PRO asphalt Sealing Tape is set before the membrane layers are set (membrane layers meet on center of PRO asphalt sealing tapes.)
4. A 1/2" bead of wedi® Joint Sealant is set over the butt seam and spread flat using a putty knife.
5. Exterior Grade Tile and Stone ANSI A137.1
6. Exterior Grade Setting Material and Grout Epoxy ANSI A118.3
7. Before wedi® Subliner Dry & Flex Pro is installed as a flashing (use primer), a Subliner Pro Asphalt Sealing strip is set into the transition corner half up on the wall, half onto the horizontal patio floor before Subliner Dry & Flex Pro is installed against the wall and the wedi® Flashing membrane is installed from wall overlapping onto the Subliner Dry & Flex Pro.
8. Metal Flashing
9. Building Wrap Overlapping Flashing

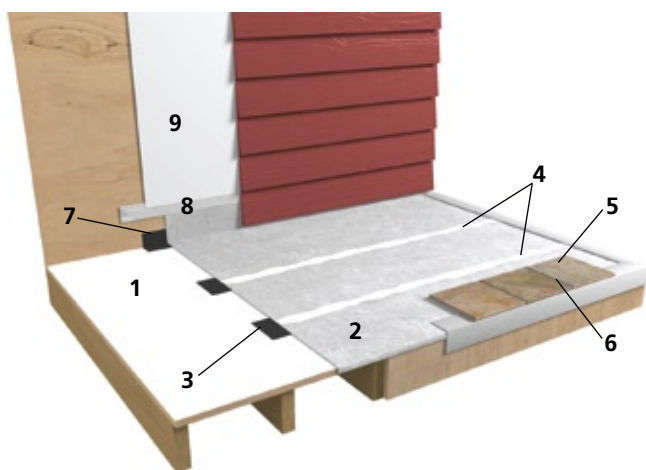
**Important:**

Brick and Stone Veneer facades need to be cut in for proper placement of flashing behind the point of water absorption. All structural wood exposed to weather to be protected. Patio must be pitched in one direction (away from building at a rate of 1/4"/ft.).

Protrusions can be sealed using wedi® Subliner Dry and wedi® Joint Sealant in combination, installed under wedi® Subliner Dry & Flex Pro. When using sealants around posts and railings make sure you use sealant that is compatible with asphalt. wedi® Joint Sealant works with wedi® Asphalt based systems but will discolor slightly, taking on a greenish tint.

16" (406 mm) o.c. joist spacing—single layer plywood or OSB subfloor

- Design wood floor areas with maximum joist spacing 16" (406 mm) o.c. over which tile is to be applied to have a deflection not greater than 1/360 of the span when measured under 300 lb. concentrated load (see ASTM C627). Follow IRC and ICC regulations and local building codes.
- Minimum subfloor thickness is 5/8" (16 mm) tongue and groove with 1/8" (3 mm) gap in between sheets.
- Minimum tile size 2" x 2" (50 mm x 50 mm).

19.2" (488 mm) o.c. joist spacing—single layer plywood or OSB subfloor

- Design wood floor areas with maximum joist spacing 19.2" (488 mm) o.c. over which tile is to be applied to have a deflection not greater than 1/360 of the span when measured under 300 lb. concentrated load (see ASTM C627). Follow IRC and ICC regulations and local building codes.
- Minimum subfloor thickness is 3/4" (19 mm) tongue and groove with 1/8" (3 mm) gap in between sheets.
- Minimum tile size 2" x 2" (50 mm x 50 mm).

24" (610 mm) o.c. joist spacing—double layer plywood or OSB subfloor

- Design wood floor areas with maximum joist spacing 24" (610 mm) o.c. over which tile is to be applied to have a deflection not greater than 1/360 of the span when measured under 300 lb. concentrated load (see ASTM C627). Follow IRC and ICC regulations and local building codes.
- Minimum subfloor thickness is a double layer of 3/4" (19 mm) tongue and groove with 1/8" (3 mm) gap in between sheets.
- Minimum tile size 2" x 2" (50 mm x 50 mm).

Natural Stone Installation Over wedi® Subliner Dry & Flex PRO

- Design wood floor areas with maximum joist spacing 19.2" (488 mm) o.c. over which tile is to be applied to have a deflection not greater than 1/720 of the span when measured under 300 lb. concentrated load (see ASTM C627). Follow IRC and ICC regulations and local building codes.

Technical Data Sheet:

wedi® Subliner Dry & Flex PRO | Waterproofing, Anti-Fracture & Sound Reducing Membrane

- Minimum subfloor thickness is a double layer of 3/4" (19 mm) tongue and groove with 1/8" (3 mm) gap in between sheets.
- Use the appropriate setting material for certain moisture sensitive stones.

Concrete Subfloors:

- Concrete and lightweight concrete at least 3 months old.
- Cracks must be securely filled.
- Use a deep penetrating primer such as wedi® PRO Primer.
- Evenness must be ensured, no laying on bowl-shaped subfloors.
- The residual humidity must not exceed the following values:
 - Cement screeds* 3.5 %
 - Calcium sulphate screeds* 0.5 %
 - Calcium sulphate screeds, heated* 0.3 %
 - Gypsum-bound plaster/underlayment (measured with CM device) 1.0 % (consider priming if recommended by manufacturer of underlayment)

* Note that wedi® Subliner Dry & Flex PRO might trap rising moisture from unisolated concrete ground floors, or vapor rising through ceiling over occupied living spaces.

Installation On Floors

1. Apply primer according to installation instructions.
2. Lay out wedi® Subliner Dry & Flex PRO with the release liner side down. Cut to size using a cutter or scissors. Cut the membrane length 6" to 8" longer to allow for a trimmed fit. On exterior surfaces, lay joints parallel to wall of building and start at front edge of surface.
3. Pull release paper off membrane while applying wedi® Subliner Dry & Flex PRO. Press on by hand and smooth out possible air pockets, ensuring good bond and 100% contact with subfloor.*
4. The sheets must be butted tightly at joints and transitions, and a meshtape is to be applied over the seams. In waterproofing applications, wedi® PRO Asphalt Sealing Strips should be installed under the seams where the Subliner Dry & Flex Pro sheets meet. Finally a 1/2" bead of wedi® Joint Sealant is applied over all seams and spread flat.
5. Trim excess material as needed at walls, corners or termination areas.

6. Cross joints should be avoided.
7. In the area of protrusions and drains, wedi® Subliner Dry waterproof membrane is installed first and sealed against the object using wedi® Joint Sealant. Subliner Dry & Flex PRO is then installed over wedi® Subliner Dry and sealed with wedi® Joint Sealant against the object.
8. Subliner Dry & Flex PRO must be separated over existing movement joints, building separation joints and edge connection joints.
9. Movement joints must be installed in subfloor according to building code requirements.

* Note that wedi® Subliner Dry & Flex PRO might be extremely hard to remove once applied. In cold climates, we recommend epoxy based setting and grouting materials made for exterior use.

Setting Tile On wedi® Subliner Dry & Flex PRO on Floors

1. wedi® Subliner Dry & Flex PRO can be tiled over immediately.
2. For tile laying, modified thinset mortar according to ANSI A118.4-1999 is applied to wedi® Subliner Dry & Flex PRO and the tiles are then embedded over the full surface.
3. For coverings subject to chemical stress, suitable reaction resin bond mortars and grout joint fillers (epoxy) must be used. Especially dense and smooth tile and stone with low absorbance should be installed with modified thinset mortars according to ANSI A118.4-1999.
4. Grout may be installed 24-48 hours after tile installation (depending on climatic conditions, tile size, grout choice [grout – ANSI A118.3, A118.6, A118.7] and thinset mortar manufacturers recommendations).
5. Expansion joints must be installed according to specifications and building code requirements.
6. In exterior applications, epoxy thinsets ANSI A118.3 with full coverage, low absorbing Tile ANSI A137.1 and Epoxy grout ANSI A118.3 are used. On patios and similar applications, a pitch and proper flashing according to building codes are mandatory for the system to work successfully. Cover the application against weather until tiling and grouting can start and is completed. Perform a waterproofness test and document the results before tiling begins.

Technical Data Sheet:

wedi® Subliner Dry & Flex PRO | Waterproofing, Anti-Fracture & Sound Reducing Membrane

Physical Properties

Material Composition	100% polypropylene nonwoven coated with rubberized asphaltic pressure sensitive adhesive
Color Top Side	White fabric/Black adhesive
Width	40 in/1016 mm
Length	50 ft/15 m
Thickness	50 mil (tolerance +/- 5 mil)
Area	166 ft ²
Application Temperature	+40°F to +210°F/ +4°C to +99°C
Service Temperature after Installation	-40°F to +210°F/ -40°C to +98°C
Waterproof ANSI A118.10-1999	Passed
Robinson Floor Test ASTM C 627	Rating "HEAVY" for shopping malls, stores, commercial kitchens, work areas, laboratories, auto showrooms and service areas, shipping/receiving, and exterior decks*

wedi® Subliner Dry & Flex PRO has been independently tested at the Tile Council of North America and found to meet or exceed the requirements of the American National Standard Specifications for Crack Isolation Membranes for Thin-Set Ceramic Tile and Dimensional Stone Installation ANSI A118.12 . The Rating is "High Performance" .

Fungus and Micro Organism Resistance	Shall not support growth	Passed
4-week Shear Strength (5.1.5)	37 PSI	High Performance 20 PSI
Shear Strength at 0.0625 in. deflection	31 PSI	
Shear Strength at 0.125 in. deflection	34 PSI	
Accelerated Aging Shear Strength (5.1.6)	113 PSI	High Performance 20 PSI
Shear Strength at 0.0625 in. deflection	83 PSI	
Shear Strength at 0.125 in. deflection	105 PSI	
Point Load Test (5.2)		
Sample 1	689 PSI	
Sample 2	563 PSI	
Sample 3	571 PSI	
System Crack Resistance Test (5.4)		Passed/High Performance
Specimen 1	No Crack	
Specimen 2	No Crack	
Specimen 3	No Crack	

* A modified thinset mortar according to ANSI A118.4-1999 has been used for best results.

Technical Data Sheet:

wedi® Subliner Dry & Flex PRO | Waterproofing, Anti-Fracture & Sound Reducing Membrane

wedi® Subliner Dry & Flex PRO has been independently tested at the Tile Council of North America and found to meet or exceed the requirements of the American National Standard Specifications for Load Bearing, Bonded, Waterproof Membranes for Thinset Ceramic Tile and Dimensional Stone Installation ANSI A118.10-1999

Sound Control & Reduction Properties Sound Test DELTA (Tapping Test) & FIC	
Test Method DELTA	ASTM 2179
DELTA IIC effectiveness	20 (8" slab without suspended ceiling)
Date	July 2008; Tested by an independent NAVLAP certified acoustical laboratory in accordance with ASTM E2179 and ASTM E1007
Test Method FIC	ASTM 1007-04
DELTA FIC effectiveness	58 (8" slab without suspended ceiling)
Date	March 2009, Tested by D.L. Adams Associates Inc. consultants in acoustics in accordance with ASTM E1007 and ASTM E989

Packaging Unit

L x W – 40 in. x 50 ft. (1016 mm x 15 m)

Storage

Store in a dry, cool place. Storable in original packaging for at least 12 months. Do not permanently store above + 30°C/ 41°F.

Disposal

wedi® Subliner Dry & Flex PRO is physiologically harmless. Disposal of the material does not involve any hazardous waste. Cutting residues and compounds of coating and wedi® Subliner Dry & Flex PRO can be disposed of as building site waste.

Warranty

The technical information (and application instructions) is based on our experience and present knowledge. However, it is the responsibility of the user/buyer to make trials with the original substrates in order to verify the suitability of our products for the intended purpose, taking into consideration all application parameters. In waterproofing applications perform a waterproofness test and document it before tiling begins. wedi's responsibility and liability with respect to defective products and/or work attaching thereto shall be confined solely to the replacement of the same. In addition, wedi® has the right to reimburse the buyer the purchase price paid with respect thereto rather than to replace the defective products.

MasterFormat™ 2004 Sections

Division 7/Thermal & Moisture Protection
07 10 00 Dampproofing & Waterproofing
Division 9/Finishes
09 31 00 Thinset Tiling
09 60 00 Sound Control Underlayment
09 80 00 Acoustical Treatments

Please visit www.wedicorp.com for additional information.

**wedi Corporation**

1100 Landmeier Road, Suite 200
Elk Grove Village, Illinois 60007
Tel. 877-933-WEDI (9334)
Fax. 847-357-9819
info@wedicorp.com
www.wedicorp.com